

Fan Court, Longcross Road, KT16

Approximate Area = 352.6 sq m / 3795 sq ft (Including Loft / Excluding Void)

Garage = 18.6 sq m / 200 sq ft

Total = 371.2 sq m / 3995 sq ft

Including Limited Use Area (37.2 sq m / 400 sq ft)

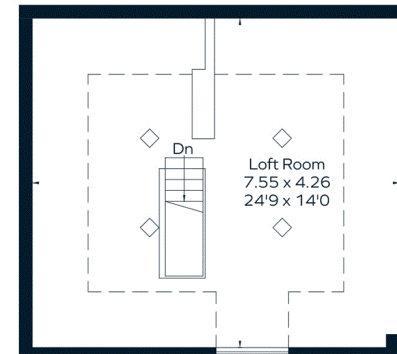

Second Floor

