

LONDON ROAD

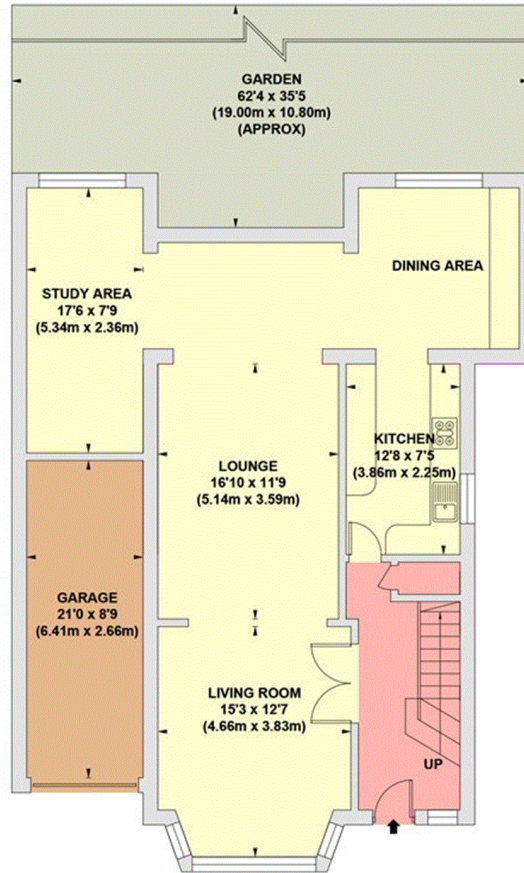

Approximate Gross Internal Floor Area
Ground Floor = 998 sqft / 92.7 sqm
First Floor = 696 sqft / 64.7 sqm
Garage = 161 sqft / 15.0 sqm
Total = 1855 SQFT / 172.4 SQM



GROUND FLOOR

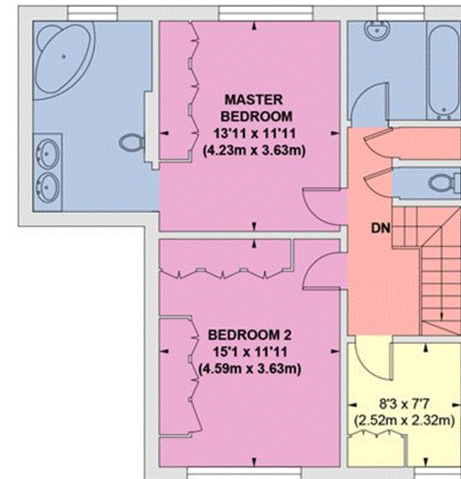

FIRST FLOOR

This plan is for layout guidance only. Not drawn to scale unless stated. Windows and door openings are approximate. Whilst every care is taken in the preparation of this plan, please check all dimensions, shapes and compass bearings before making any decisions reliant upon them.

© C J Property Marketing Ltd Produced for Preston Bennett - Stanmore