

Approximate Area = 63.8 sq m / 686 sq ft
Including Limited Use Area (1.4 sq m / 15 sq ft)

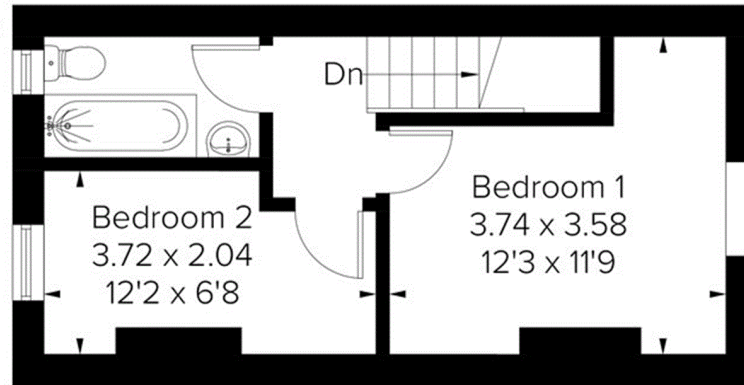

= Reduced head height below 1.5m



First Floor

Area = 27.2 sq m / 292 sq ft
(Limited Use Area = 0.2 sq m / 2 sq ft)



Ground Floor

Area = 36.6 sq m / 394 sq ft
(Limited Use Area = 1.2 sq m / 13 sq ft)