

Templars Place, Marlow

Approximate Gross Internal Area = 111.9 sq m / 1205 sq ft

Garage = 13.5 sq m / 145 sq ft

Boiler Room = 1.2 sq m / 23 sq ft

Total = 126.6 sq m / 1363 sq ft

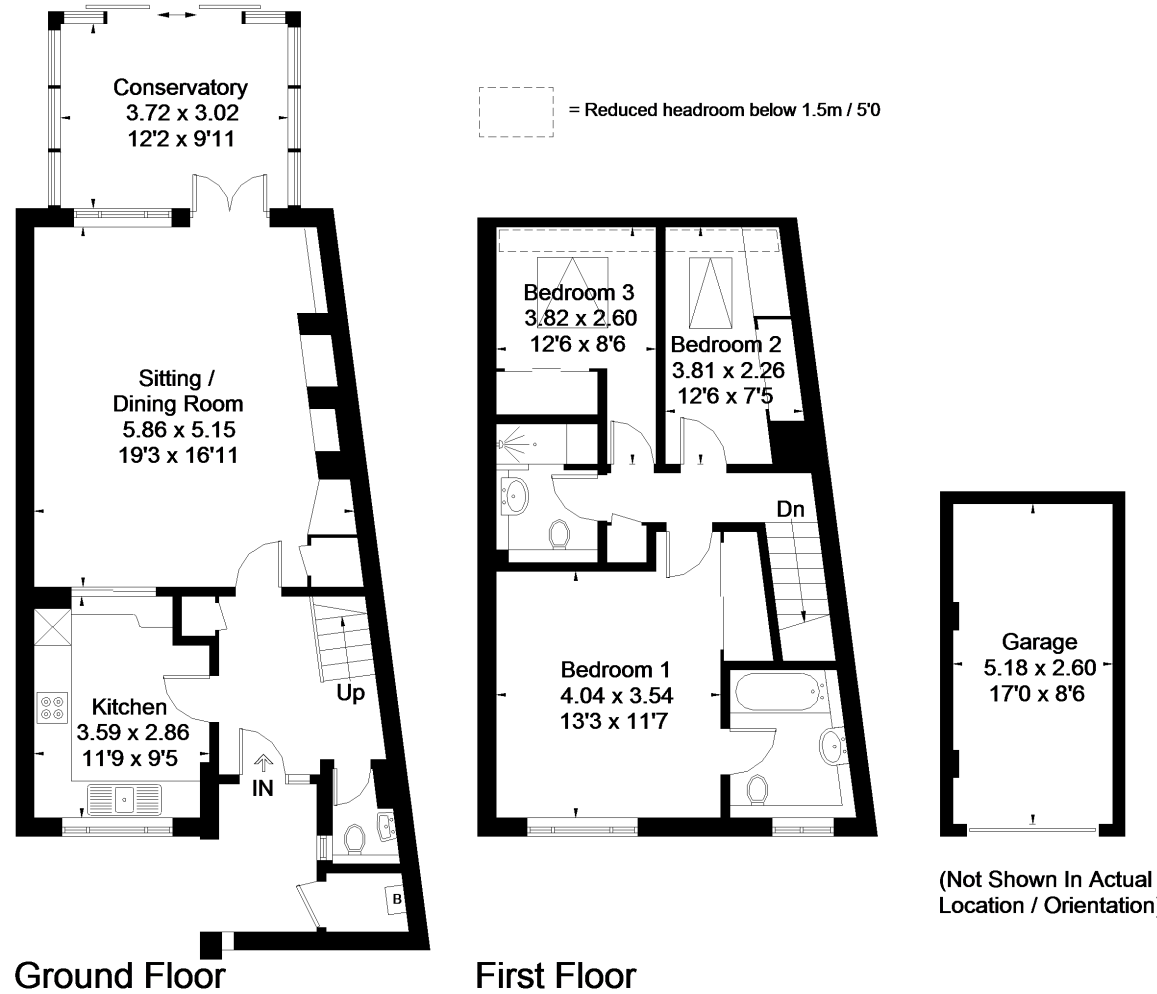

FLOORPLANZ © 2017 0203 9056099 Ref: 194836

This plan is for layout guidance only. Drawn in accordance with RICS guidelines. Not drawn to scale unless stated. Windows & door openings are approximate. Whilst every care is taken in the preparation of this plan, please check all dimensions, shapes & compass bearings before making any decisions reliant upon them.