

Primrose Lane, Rake, Liss

Approximate Gross Internal Area = 122.4 sq m / 1317 sq ft
Garage = 26.9 sq m / 289 sq ft
Total = 149.3 sq m / 1606 sq ft

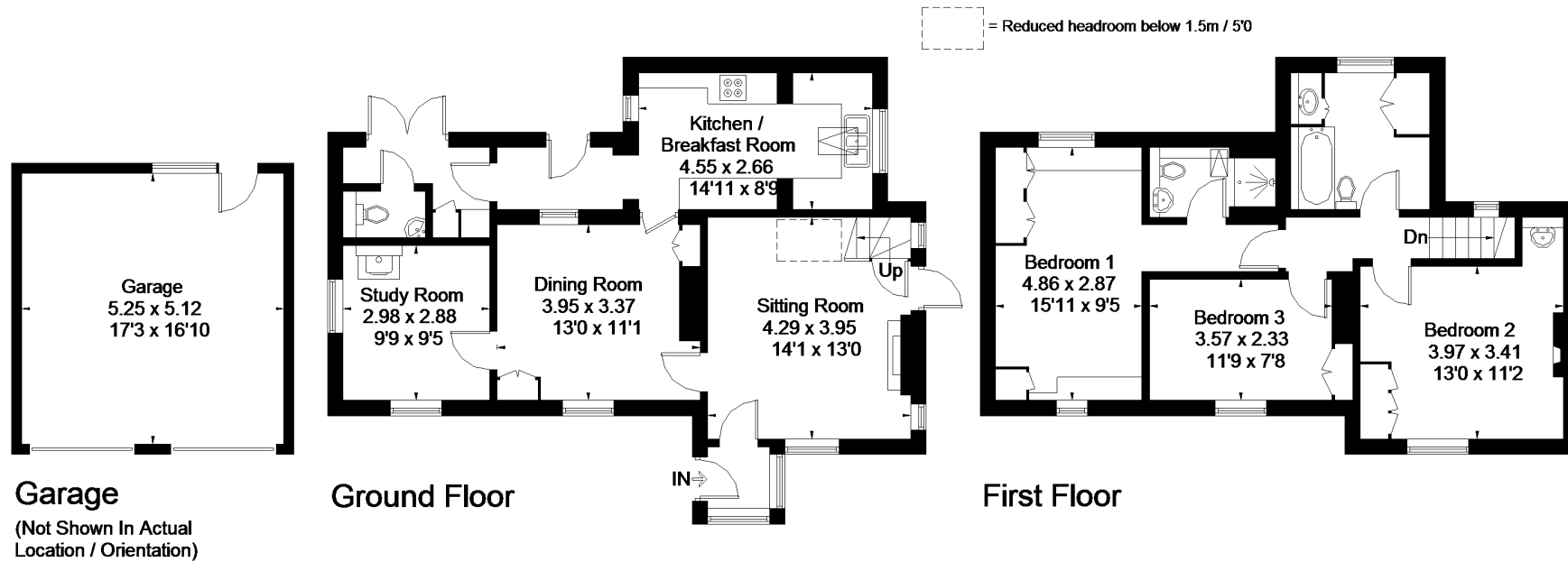

FLOORPLANZ © 2019 0203 9056099 Ref: 224463

This plan is for layout guidance only. Drawn in accordance with RICS guidelines. Not drawn to scale unless stated. Windows & door openings are approximate. Whilst every care is taken in the preparation of this plan, please check all dimensions, shapes & compass bearings before making any decisions reliant upon them.