

GROUND FLOOR

APPROX. 93.6 SQ. METRES (1007.2 SQ. FEET)



FIRST FLOOR

APPROX. 72.4 SQ. METRES (779.8 SQ. FEET)

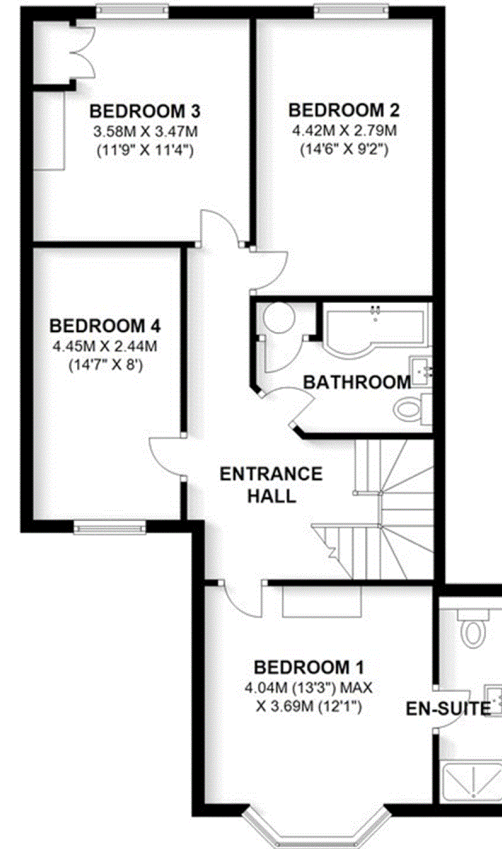

TOTAL AREA: APPROX. 166.0 SQ. METRES (1787.0 SQ. FEET)

For Identification purposes, not to scale.
Plan produced using PlanUp.