

Approximate Area = 117.6 sq m / 1265 sq ft  
Including Limited Use Area (1.9 sq m / 20 sq ft)

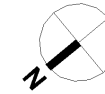

= Reduced head height below 1.5m

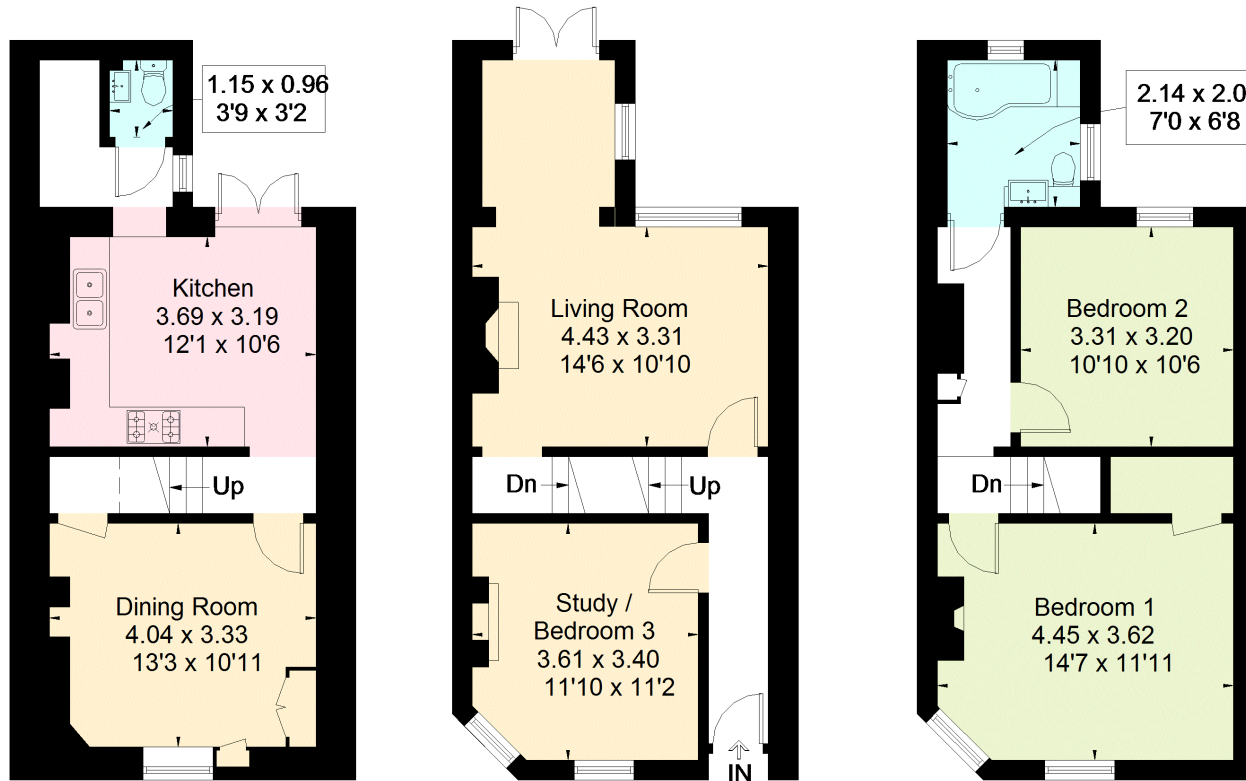

### Lower Ground Floor

Area = 36.1 sq m / 388 sq ft  
(Limited Use Area = 0.8 sq m / 9 sq ft)

### Ground Floor

Area = 40.8 sq m / 439 sq ft  
(Limited Use Area = 0.7 sq m / 7 sq ft)

### First Floor

Area = 40.7 sq m / 438 sq ft  
(Limited Use Area = 0.4 sq m / 4 sq ft)