

Gossamer Lane, Bognor Regis

Approximate Gross Internal Area = 103.5 sq m / 1114 sq ft
Garage = 25.9 sq m / 279 sq ft
Total = 129.4 sq m / 1393 sq ft

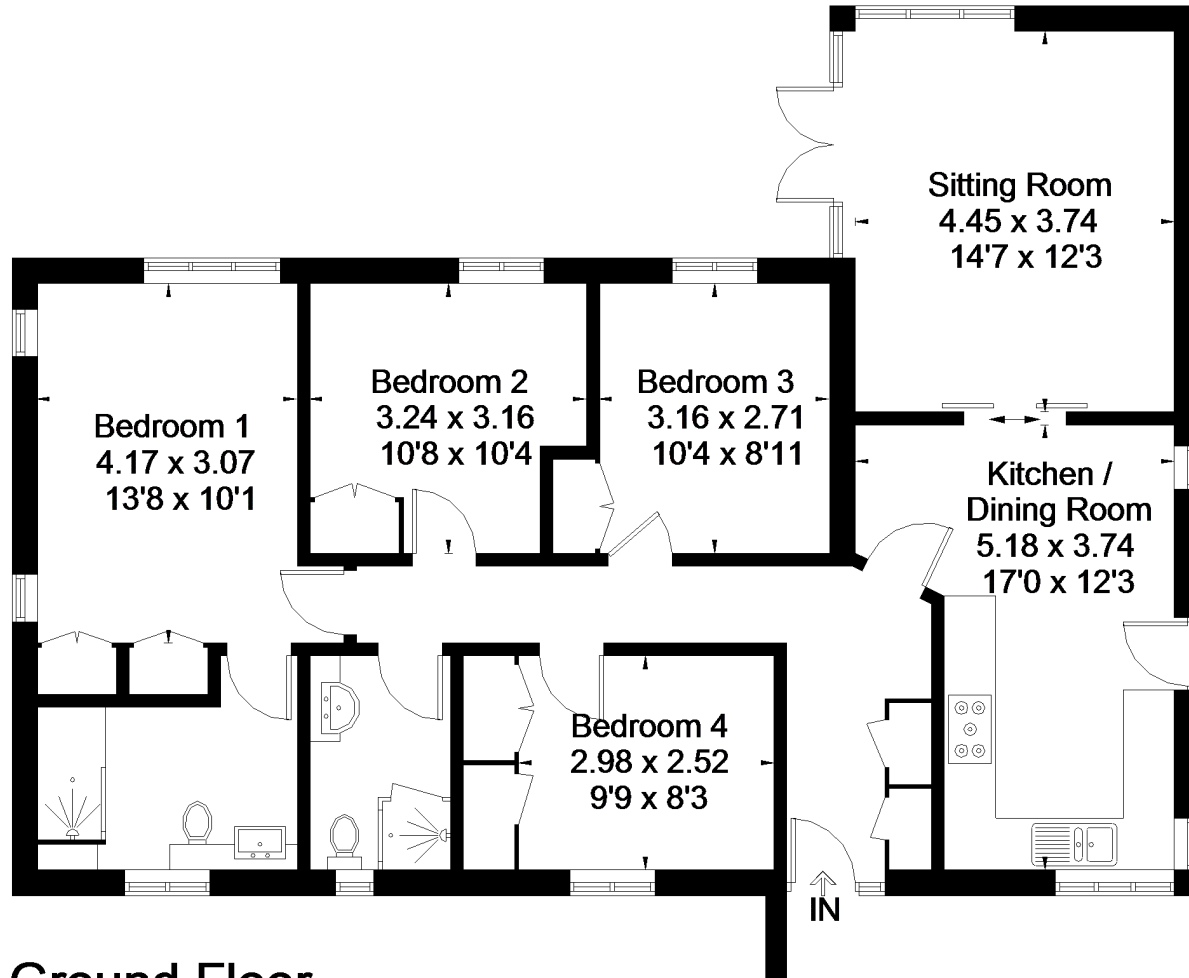

Ground Floor

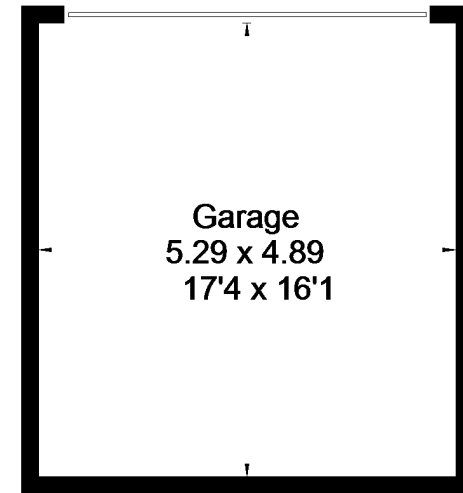

(Not Shown In Actual Location / Orientation)

FLOORPLANZ © 2018 0203 9056099 Ref: 222384

This plan is for layout guidance only. Drawn in accordance with RICS guidelines. Not drawn to scale unless stated. Windows & door openings are approximate. Whilst every care is taken in the preparation of this plan, please check all dimensions, shapes & compass bearings before making any decisions reliant upon them.