

Newells Lane, West Ashling, Chichester

Approximate Gross Internal Area = 189.8 sq m / 2043 sq ft (Excluding Void)

Garage = 49.1 sq m / 528 sq ft

Outbuilding = 8.1 sq m / 87 sq ft

Total = 247 sq m / 2658 sq ft

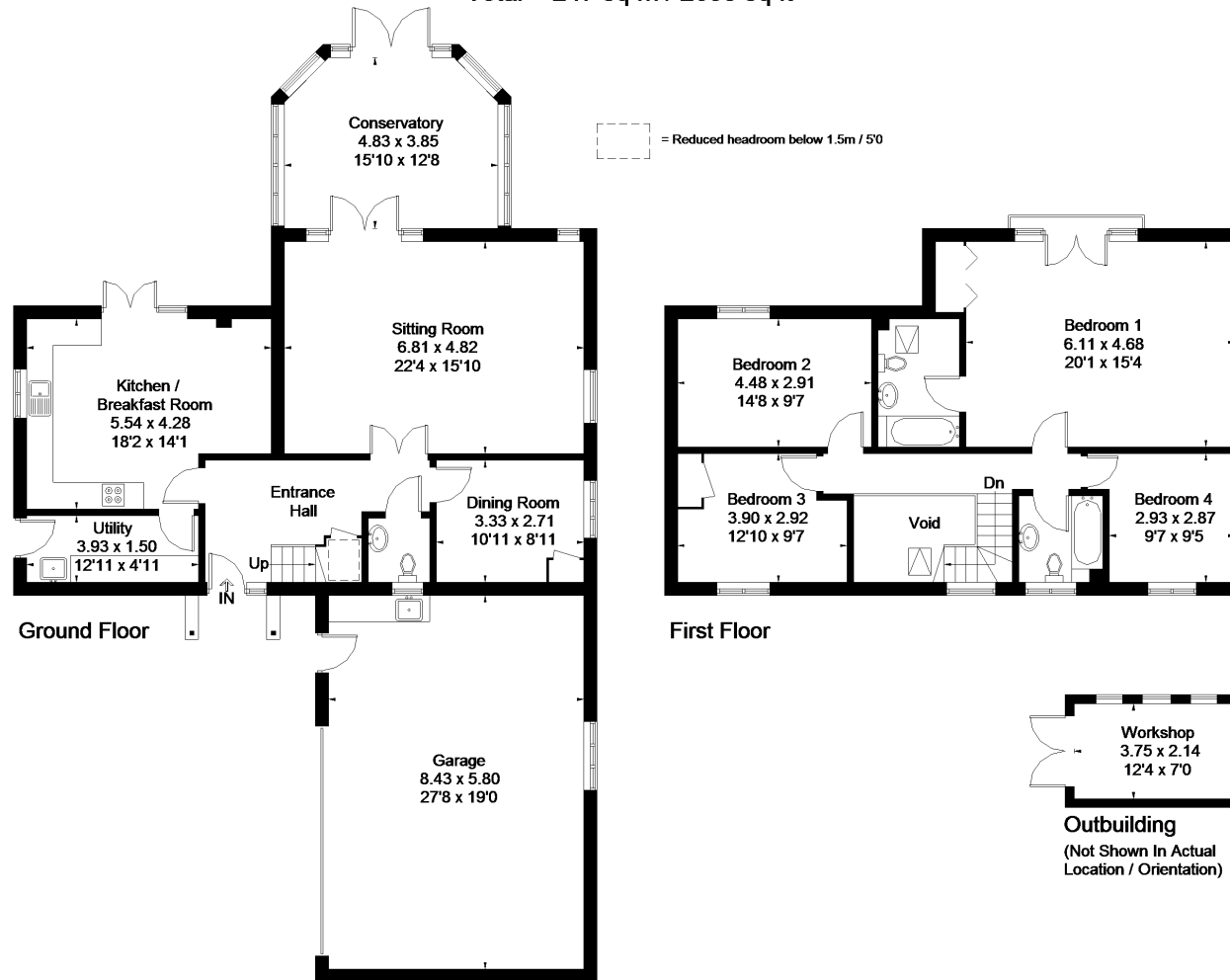

FLOORPLANZ © 2018 0203 9056099 Ref: 213251

This plan is for layout guidance only. Drawn in accordance with RICS guidelines. Not drawn to scale unless stated. Windows & door openings are approximate. Whilst every care is taken in the preparation of this plan, please check all dimensions, shapes & compass bearings before making any decisions reliant upon them.