

THE VILLIERS | HOMES 8, 9, 10 & 11

This stylish home is ideal for young families, with three comfortable bedrooms and thoughtfully designed reception areas, complete with a practical utility room, it is perfect for family time.

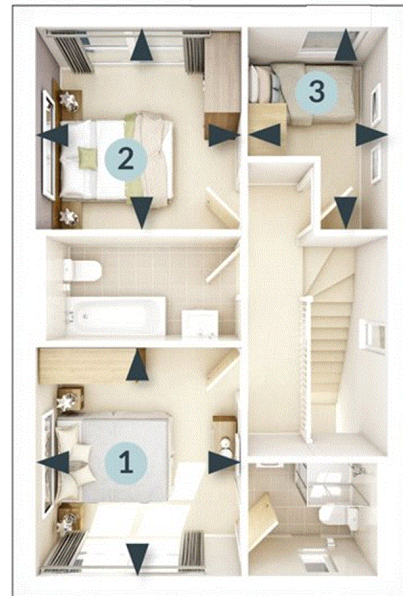
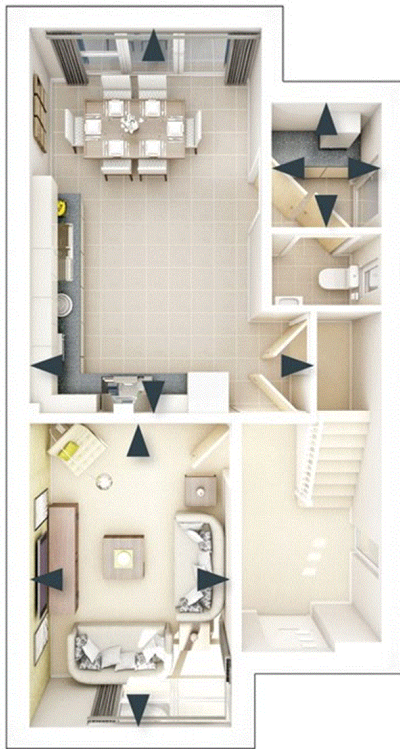

GROUND FLOOR

LIVING ROOM	4550mm x 3036mm	14' 11" x 10'
KITCHEN/DINER	5773mm x 4123mm	18' 11" x 13' 6"
UTILITY ROOM	1862mm x 1650mm	6' 1" x 5' 5"

FIRST FLOOR

BEDROOM 1	3093mm x 3425mm	10' 2" x 11' 3"
BEDROOM 2	3093mm x 3029mm	10' 2" x 9' 11"
BEDROOM 3	2100mm x 3028mm	6' 11" x 9' 11"

Homes 9 & 11 are handed

All floor plans and CGIs are of a house type and do not necessarily reflect the detail of any particular home, these are used for illustrative purposes only and should not be relied upon. External materials, landscaping, garage position/attachment, window/door position, handing and external works may vary to the information shown. Please ask a sales adviser for more information. All dimensions are accurate to within 50mm and where given are maximums which include any fitted wardrobes or similar features. Furnishings on the above floor plans, including but not exclusive to kitchens, bathrooms, en suites and W/C layouts are indicative only and should not be relied upon. Interior furnishings are not included with the sale of any property.