

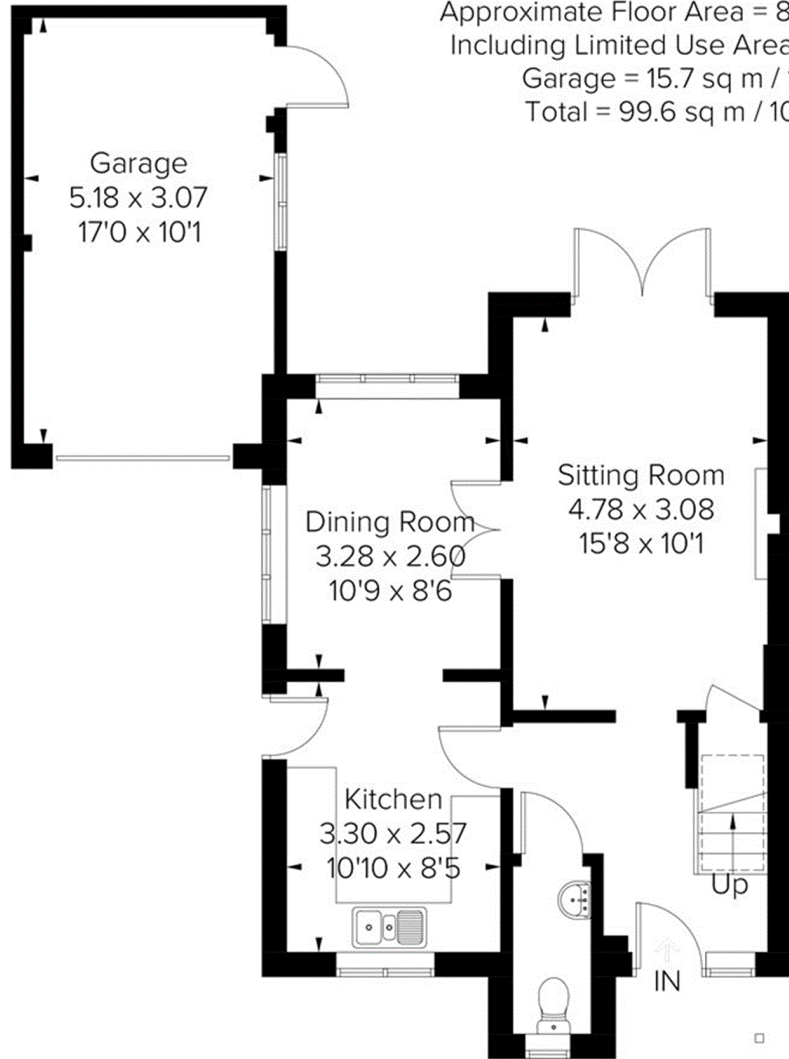

Approximate Floor Area = 83.9 sq m / 903 sq ft
 Including Limited Use Area (1.7 sq m / 18 sq ft)
 Garage = 15.7 sq m / 169 sq ft
 Total = 99.6 sq m / 1072 sq ft

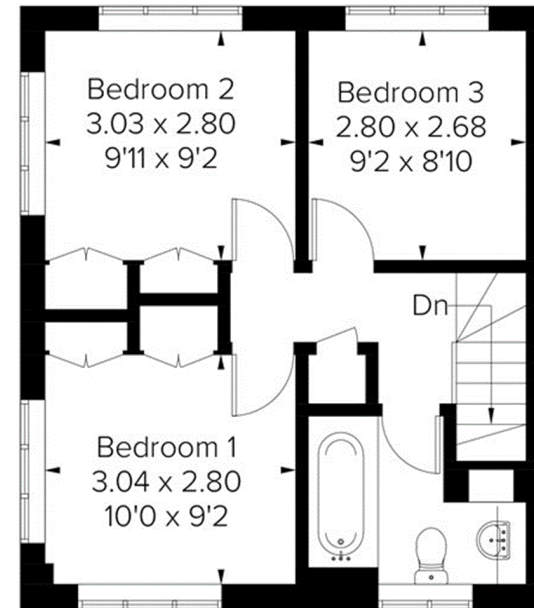

= Reduced head height below 1.5m



Ground Floor

Area = 44.4 sq m / 478 sq ft
 (Limited Use Area = 1.7 sq m / 18 sq ft)

Area = 15.7 sq m / 169 sq ft

First Floor

Area = 39.5 sq m / 425 sq ft